

Disney's Coronado Springs Resort

Disney Meetings & Events
Facility Reference Guide

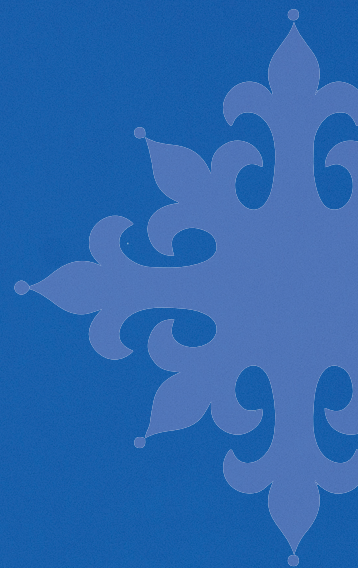

Overview

Celebrate the unique blend of Spanish, Mexican and Southwest American cultures at *Disney's Coronado Springs Resort*. From the moment you enter the stunning 15-story Gran Destino Tower—you'll find yourself immersed in a unique blend of contemporary design and old-world traditions. This beautiful lakeside oasis offers modern influences, Disney touches and classic comforts to energize and inspire as you delight in an array of new amenities, eateries, and enhancements.

Highlights

- Nearly 228,000 sq. ft. of indoor and outdoor function space
- Nearly 86,000 sq. ft. exhibit hall
- 2,416 guest rooms and suites
- 64 Suites
- 10 loading docks providing convenient truck access
- 4 full-service restaurants and 3 private dining rooms
- 6 Lounges
- 4 Quick-Service Dining Options
- 5 permanent registration counters
- 4 swimming pools and a walking/jogging trail
- Well-equipped boardroom that seats up to 24 guests
- Charming private patios and a tranquil lakeside beach for outdoor events
- Full-service business center
- On-site marshalling yard that connects to the entire convention center
- High capacity internet connectivity and hard-wired services in meeting rooms, ballrooms, exhibit halls and convention foyers at little to no cost
- Complimentary Wi-Fi available in the guest rooms and public areas of the Resort
- 2 Fitness centers, Spa and Salon services
- Complimentary bus transportation to *Disney Springs* and all four Theme Parks



Dining & Lounges

Uniquely themed restaurants and lounges make up the wide variety of dining options found throughout Disney's Coronado Springs Resort. Explore our vast collection of dining venues.



Villa del Lago



Toledo - Tapas, Steak & Seafood



Barcelona Lounge

Barcelona Lounge

Offering central seating and serene lake views, this space transforms throughout the day, providing coffee in the morning and cocktails in the evening.

Dahlia Lounge

Cocktails and spectacular views are served up in this rooftop lounge featuring whimsical forms, colors, and unique lighting inspired by Spanish surrealism.

El Mercado de Coronado

There's something for everyone in this light and airy dining spot serving breakfast, lunch and dinner.

Maya Grill

Explore a variety of Mexican inspired flavors at this specialty dining location.

Rix Sports Bar & Grill

Delight in breakfast, lunch or dinner at this modern eatery. Enjoy handcrafted cocktails, local draft beers and a unique spin on classic sports fare.

Siestas Cantina Pool Bar

Unwind with a bite to eat and specialty cocktails at this peaceful poolside hideaway.

Three Bridges Bar & Grill at Villa del Lago

At Villa del Lago, convention attendees can gather individually or in groups to mingle, network and connect in a beautiful setting over the water.

Toledo – Tapas, Steak & Seafood

Savor dishes and small plates inspired by the flavors of Spain while feasting your eyes on the sweeping views from this rooftop restaurant.

Disney's Coronado Springs Resort Floor Plan

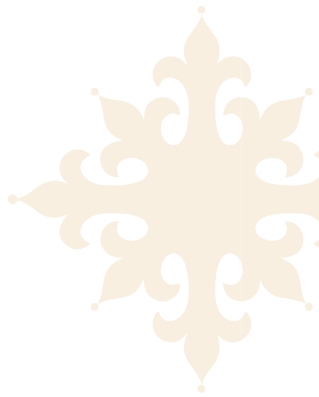
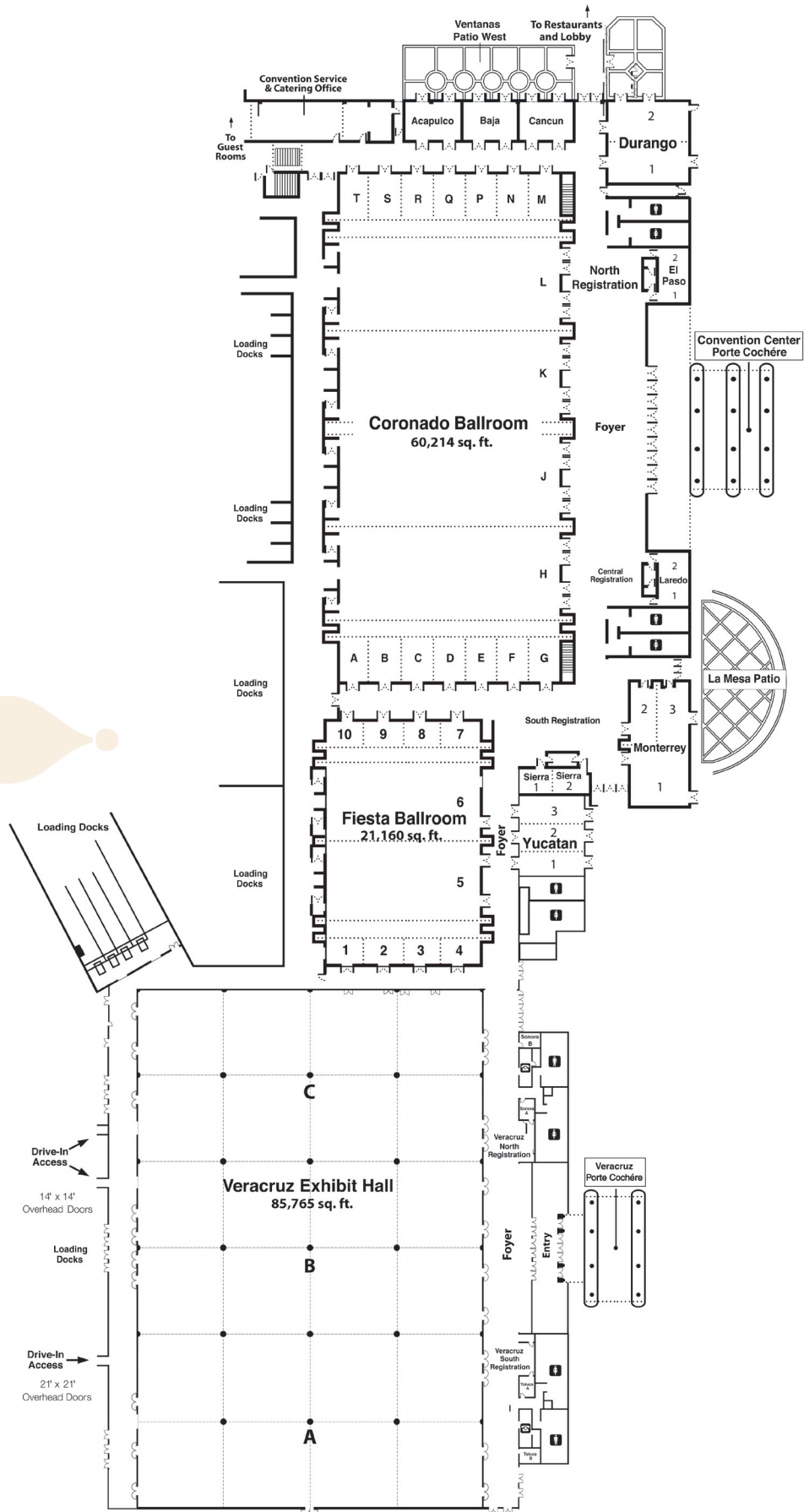

Room Name	Square Feet	Width	Length	Ceiling Height	Theater	School Room	Banquet Rounds of 10	Banquet Rounds of 12	Reception	10' x 10' Exhibit	8' x 10' Exhibit
Veracruz Hall	85,765	362	238	23	5,280	3,720	4,780	5,736	3,700	462	472
Veracruz A	28,322	119	238	23	1,512	1,272	1,090	1,308	1,200	151	160
Veracruz B	29,512	124	238	23	1,750	1,332	1,140	1,368	1,300	166	166
Veracruz C	28,322	119	238	23	1,512	1,232	1,090	1,308	1,200	146	160

Room Name	Square Feet	Width	Length	Ceiling Height	Theater	School Room	Conference	U-shape	Banquet Rounds of 10	Banquet Rounds of 12	Reception
Coronado Ballroom	60,214	374	161	23	6,684	3,555	2,598	•	4,800	5,700	5,778
Coronado H-L (each)	11,109	69	161	23	1,600	690	•	80	910	1,080	1,119
Coronado H w/Service Hall	13,041	81	161	23	1,610	897	•	•	1,090	1,248	1,224
Coronado L w/Service Hall	13,041	81	161	23	1,610	897	•	•	1,090	1,248	1,224
Coronado A-H	18,515	115	161	23	2,565	984	812	•	1,260	1,512	1,699
Coronado A-J	29,624	184	161	23	4,050	1,881	•	•	2,250	2,700	2,784
Coronado A-G (each)	782	23	34	23	72	42	28	30	50	60	78
Coronado M-T (each)	782	23	34	23	72	42	28	30	50	60	78
Fiesta Ballroom	21,160	184	115	23	2,650	1,428	•	•	1,700	2,040	1,699
Fiesta 5, 6 (each)	6,555	57	115	23	832	408	80	80	560	672	650
Fiesta 5 w/Service Hall	7,935	69	115	23	1,054	543	•	•	630	756	775
Fiesta 6 w/Service Hall	7,935	69	115	23	1,054	543	•	•	630	756	775
Fiesta 1-5	10,580	92	115	23	1,278	560	•	•	850	1,020	1,055
Fiesta 6-10	10,580	92	115	23	1,278	560	•	•	850	1,020	1,055
Fiesta 1-4 (each)	667	23	29	23	64	38	28	30	40	48	67
Fiesta 7-10 (each)	667	23	29	23	64	38	28	30	40	48	67
Acapulco	972	27	36	14	92	54	34	30	60	72	100
Baja	972	27	36	14	92	54	34	30	60	72	100
Cancun	972	27	36	14	92	54	34	30	60	72	100
Durango 1, 2 (each)	1,515	27	57	16	166	84	42	54	80	96	150
Durango 1 & 2	3,030	54	57	16	260	171	52	78	160	192	350
Laredo, El Paso 1, 2 (each)	460	23	20	14	44	24	18	18	30	36	40
Laredo, El Paso 1 & 2	920	46	20	14	90	51	34	38	60	72	80
Monterrey 1	1,600	40	40	16	174	76	30	54	110	132	175
Monterrey 2, 3 (each)	800	20	40	16	70	38	28	30	50	60	75
Monterrey 2 & 3	1,600	40	40	16	160	84	28	48	110	120	130
Monterrey 1-3	3,200	80	40	16	336	168	58	84	210	252	340
Sierra 1, 2 (each)	399	19	21	14	28	18	18	18	30	36	30
Sierra 1 & 2	798	38	21	14	56	36	34	36	60	72	72
Sonora A	164	16	10	•	•	•	•	•	•	•	•
Sonora B	198	16	12	•	•	•	•	•	•	•	•
Toluca A	165	10	16	•	•	•	•	•	•	•	•
Toluca B	198	16	12	•	•	•	•	•	•	•	•
Yucatan 1-3	2,850	75	38	16	260	174	70	84	200	240	280
Yucatan 1 & 2	1,900	50	38	16	190	100	40	48	130	156	180
Yucatan 1, 2, 3 (each)	950	25	38	16	80	45	34	40	60	72	80

Outdoor Venues											
Ventanas West	•	•	•	•	•	•	•	•	•	•	80
La Mesa Patio	3,905	•	•	•	•	•	•	•	240	288	300
Casitas Courtyard	•	•	•	•	•	•	•	•	200	216	400
Cabanas Beach	•	•	•	•	•	•	•	•	500	600	1,200

Disney's Coronado Springs Floor Plan

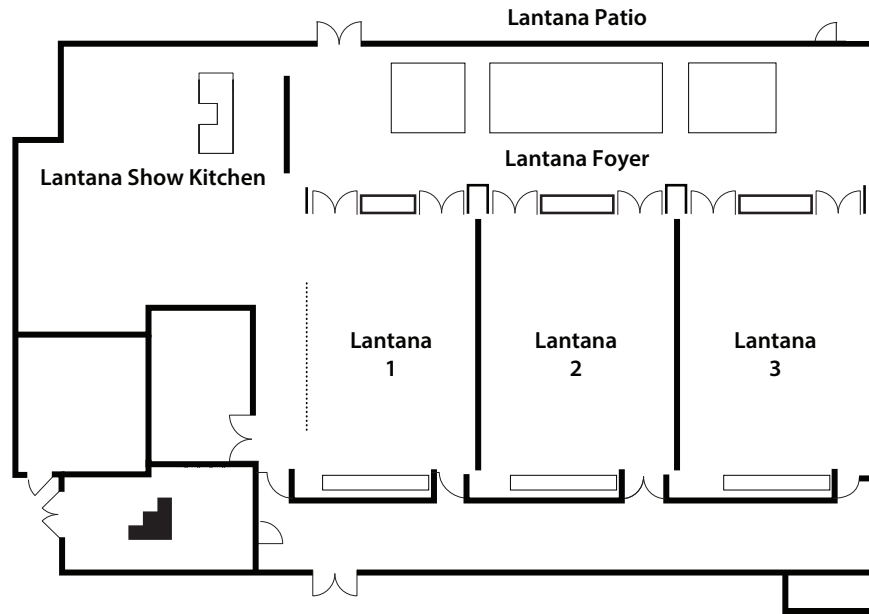

Room Name	Square Feet	Width	Length	Ceiling Height	Theater	School Room	Conference	U-shape	Rounds / Ovals	Reception
Lantana 1	987	25	35	10	70	54	30	30	50	100
Lantana 2	1,010	26	35	10	70	54	30	30	50	100
Lantana 3	862	23	35	10	60	54	30	30	40	80
Lantana 1-3	2,859	74	35	10	200	162	70	72	140	280
Lantana 1-2	1,997	51	35	10	140	108	40	54	100	200
Lantana 2-3	1,872	49	35	10	130	108	40	48	90	180
Lantana Patio	3,360	•	•	•	•	•	•	•	140	200
Catalonia Boardroom	1,138	20	52	10	•	•	24	•	•	•



Superior Accommodations

Enjoy tastefully furnished and sophisticated guest rooms and suites that appeal to the modern business.



Gran Destino Tower Room



Standard Resort Room

All guest rooms include complimentary Wi-Fi and a dedicated work station.

Select rooms offer beautiful views of the lake, pool area, garden and courtyard.



Gran Destino Tower Suite



Disney
MEETINGS & Events

We're excited to meet with you and
start planning your next meeting or group event!

For more information, please contact us at 321-939-7252

DisneyMeetings.com/disneyworld

Walt Disney World®